

# THE BENEFITS OF REFLECTIVE FOIL LAMINATES

Sisalation™ is a reflective foil laminate (RFL). It is known by the common names, sarking, wall wrap and reflective foil insulation. Gladiator™ is the name of Insulation Solutions™ tough wall wrap.

## Reflective Foil Laminates:



**Provide** a second skin against wind driven rain and dust, especially if the tiles become cracked or damaged. Manufactured to Australian Standard AS4200.1.



**Provide** a condensation barrier to protect the building fabric. Provides a vapour barrier when sealed with Vapastop™ self-adhesive aluminium foil tape.



**Are** flame retardant and suitable for use in buildings in bushfire prone areas, protects against sparks and burning embers. Has a "Low" flammability index in accordance with the Fire Standard AS1530.2 and the Bushfire Standard AS3959.



**Provide** an insulation barrier to radiant heat. Complies with the Building Code of Australia (BCA) and the Australian Standard for insulation AS/NZS4859.1



**Insulate** to improve home energy efficiency and reduces Greenhouse Gas emissions.



**Provide** a fall arrest barrier for added safety during construction (ProGuard™ and ProGuard™ Plus only).



**Provide** an added barrier against hail storm damage (ProGuard™ Plus only).

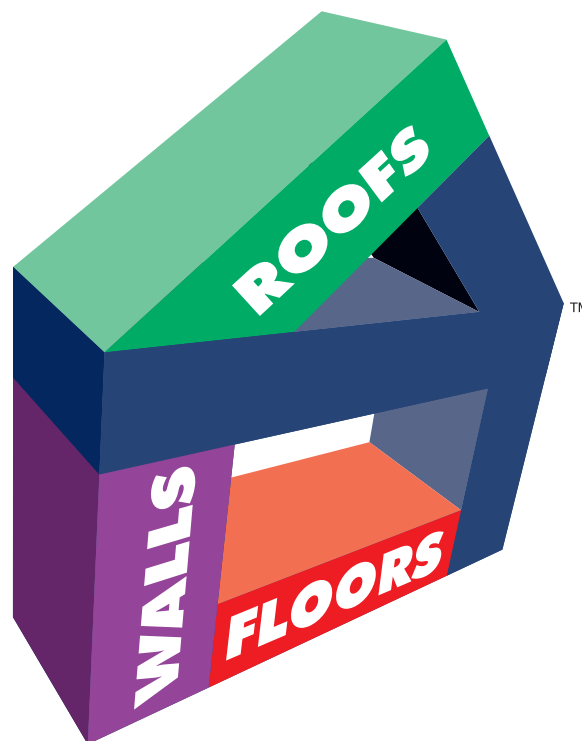

INSULATION SOLUTIONS™  
FOR SUSTAINABLE LIVING

# SISALATION™ SARKING AND WALL WRAP



PRODUCT GUIDE



INSULATION SOLUTIONS™  
FOR SUSTAINABLE LIVING

The contents of this brochure are copyright protected and may not be reproduced without the written consent of Insulation Solutions Pty. Ltd. Recommendations and advice regarding the use of the products described in this brochure are to be taken as a guide only, and are given without liability on the part of the company or its employees. We reserve the right to change product specifications without prior notification. The purchaser should independently determine the suitability of the product for the intended use and application.

Insulation Solutions Pty. Ltd. ABN 15 083 169 402

\*PINK is a registered trademark used under licence by Insulation Solutions Pty. Ltd.

™Trademarks of Insulation Solutions Pty. Ltd. \*ECOPINK is an initiative of Insulation Solutions Pty. Ltd.

©Copyright 2004 ISR12468/1 MDG-10/04

## THERMAL PERFORMANCE

Insulation is one of the most beneficial products in improving energy efficiency and reducing greenhouse gas emissions. The R-Value of reflective foil laminates is dependent on the application and direction of heat flow. R-Values for each product are specified in the *ECOPINK* selector and the '5 Stars of Insulation' brochures.



## SPECIFICATION & INSTALLATION

Correctly specified and installed Sisalation™ reflective foil laminate, Gladiator™ tough wall wrap, ProGuard™ fall arrest reflective foil laminate and ProGuard™ Plus fall arrest/hail resistant reflective foil laminate are designed to provide the benefits as described for the life of the structure.



## ROOFS/SUSPENDED FLOORS

DESCRIPTION/FOIL CODE	APPLICATION USE	DUTY/CLASSIFICATION*
<b>SISALATION 438</b> <i>Reflective Foil Laminate Double Sided, Anti-Glare</i>	Metal Roofs Brick Veneer Walls	Light Duty
<b>SISALATION 439</b> <i>Reflective Foil Laminate Double Sided, Anti-Glare</i>	Metal Roofs Brick Veneer Walls	Light Duty
<b>SISALATION 433</b> <i>Reflective Foil Laminate Double Sided, Anti-Glare</i>	Metal Roofs Brick Veneer Walls Suspended Floors	Medium duty
<b>SISALATION 453</b> <i>Reflective Foil Laminate Double Sided, Anti-Glare</i>	Metal Roofs Brick Veneer Walls	Extra Heavy Duty
<b>SISALATION 466</b> <i>Reflective Foil Laminate Double Sided, Anti-Glare</i>	Tiled Roofs	Heavy Duty
<b>SISALATION 484</b> <i>Reflective Foil Laminate Double Sided, Anti-Glare</i>	Tiled Roofs	Extra Heavy Duty
<b>PROGUARD</b> <i>Reflective Foil Laminate Anti-Glare, Fall Arrest</i>	Tiled Roofs	Extra Heavy Duty
<b>PROGUARD PLUS</b> <i>Reflective Foil Laminate Anti-Glare, Fall Arrest, Hail Resistant</i>	Tiled Roofs	Extra Heavy Duty

## TILED ROOF/FLAT CEILING

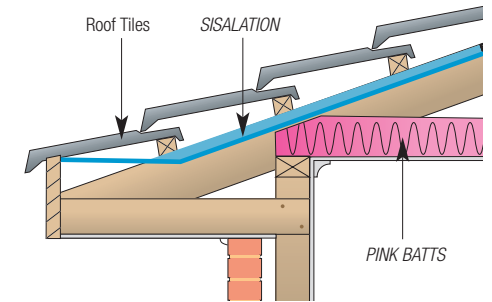

## METAL ROOF/FLAT CEILING

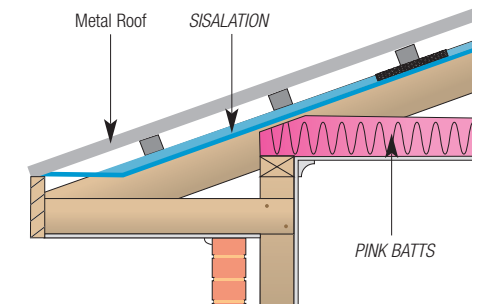

## WALLS

DESCRIPTION/FOIL CODE	APPLICATION USE	DUTY/CLASSIFICATION*
<b>SISALATION 499</b> <i>Reflective Foil Laminate, Anti-Glare, Breather Foil, Double Sided</i>	Timber Walls Fibre Cement Clad Walls	Light Duty
<b>GLADIATOR BREATHER 491</b> <i>Reflective Foil Laminate, Anti-Glare, Breather Foil</i>	Timber Walls Fibre Cement Clad Walls	Extra Heavy Duty
<b>GLADIATOR 492</b> <i>Tough Wall Wrap, Anti-Glare Reflective Foil Laminate</i>	Brick Veneer Walls	Extra Heavy Duty

\*Duty Classification in accordance with AS/NZS4200.1

## BRICK VENEER WALLS TIMBER/ FIBRE CEMENT CLAD WALLS

