

INSTALLATION OF PINK BATTS® THERMAL INSULATION IN CEILINGS AND WALLS

WHEN INSTALLED CORRECTLY, PINK BATTS® THERMAL INSULATION BATTS ARE THE MOST EFFECTIVE WAY TO INSULATE YOUR CEILING AND EXTERNAL FRAMED WALLS.

Any spaces in ceilings and walls, even those only centimeters in width, should be fitted with insulation.

All batts should fit snugly between ceiling joists or wall studs. This will prevent heat loss or gain through gaps created by incorrect fitting.

Wall cavities above manhole covers, windows or built-in robes etc are common areas often overlooked.



INSULATION SOLUTIONS™
FOR SUSTAINABLE LIVING

GUARANTEE YOUR RESULTS

Always specify and use ECOPINK® Insulation System PINK BATTS® thermal insulation batts.

CEILINGS

STEP 1. Preparation



Take care to only step on the ceiling joists, not the plasterboard, and remember to keep batts in their packs until they are in the ceiling space.

The good news is that ECOPINK® Insulation System PINK BATTS® thermal insulation batts are very light and packs can be placed into the ceiling quite easily.

If the manhole is too small, access can be gained by taking tiles off the roof – which also provide better ventilation while you work. Remember to replace any tiles when installation is completed.

Distribute the packs around the ceiling before opening. Slit the packs and open only as needed to maximize the cramped space in the ceiling.

STEP 2. Installation

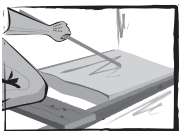

Place board across the joists as a knee rest. Begin at the most distant point from the manhole. Use the dowel as an extension of your arm to reach and position batts in cramped or hard to access areas.

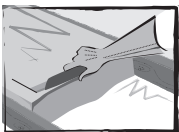

All batts should fit snugly and sit flat between the joists. Batt can be trimmed to fit irregular-spaced joists as small as 2cm wide using a knife.

Electrical wiring should be placed on top of insulation where possible.

STEP 3. Coverage

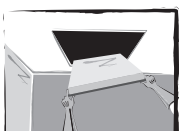

It is crucial that insulation totally covers the entire ceiling of the house, so don't forget the manhole cover.

Cut a piece of insulation to fit and glue with a suitable adhesive. Place the manhole cover back in position once adhesive has dried.

BEFORE YOU BEGIN

You will need the following tools:

- Ladder
- Tool Bag
- A sharp knife
- A one metre length of dowel rod with a nail in the end to assist in placing PINK BATTS® thermal insulation batts in hard to get at areas
- Goggles are recommended when working overhead
- For comfort wear long sleeves, cotton gloves and a button up shirt.

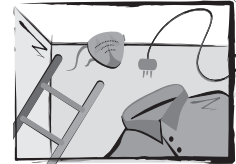

CEILINGS

- Knee pads
- Length of timber at least 150mm wide for kneeling, (placed across ceiling joists)
- A dust mask is recommended in confined ceiling spaces and dusty environments
- In extreme heat, ensure roof space is adequately ventilated to avoid discomfort

WALLS

- String line and nails for fixing to outside of studwork, (or preferably, wrap the stud wall in either Gladiator™ tough wall wrap or Sisalation™ reflective foil laminate. (This is to ensure the PINK BATTS® thermal insulation batts sit neatly in the stud wall

WALLS

STEP 1. Preparation



Before you begin to install PINK BATTS® thermal insulation, fix a series of "string lines" around the outside face of the stud wall, or preferably, wrap the stud wall in either ECOPINK® Insulation System Gladiator™ tough wall wrap or Sisalation™ reflective foil laminate. This will ensure that once the internal wall lining, (eg., plasterboard) is applied, the batts will remain in position and not fall into cavity spaces etc.

Next, place batt packs around the wall perimeter, do not open packs until you are ready to install the batts.

STEP 2. Installation



PINK BATTS® thermal insulation batts are available in 430mm and 580mm widths. These sizes suit most standard timber framed walls, (stud spacings being either 450mm or 600mm).

Begin installing batts ensuring that they fit snugly between the studs. Batt can be trimmed to fit irregular-spaced studs as small as 2cm wide using a knife.

Where necessary, use the dowel to position batts that are too high to reach from floor level. Where it is necessary to use a ladder to reach higher areas, DO NOT stand on the ladder higher than two metres off the floor.

STEP 3. Coverage



It is crucial that insulation totally covers the entire wall area of the house, so don't forget areas such as above windows or in corners where several studs may be fixed leaving small spaces.

Cut pieces of insulation to snugly fit these areas.