

# SISALATION™ 484

## Extra Heavy Duty Foil Laminate



### PRODUCT DESCRIPTION

Insulation Solutions™ *Sisalation 484* is manufactured with an outer layer of aluminium foil bonded to a high density kraft paper. This in turn is bonded to high density polymer weave fabric and further reinforced with fibre glass yarn using a flame retardant adhesive. The top film surface is blue to reduce any problems with reflected glare during installation.

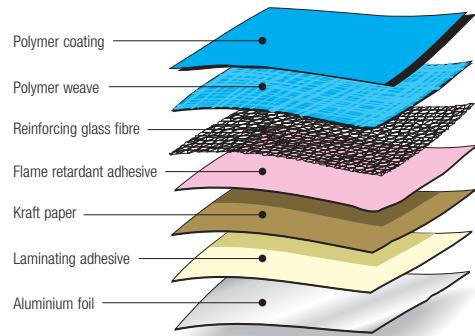

### PRODUCT APPLICATION

*Sisalation 484* is designed for use in demanding applications that require extra resistance to puncturing and tearing, particularly as a result of traffic which is common during installation of roof tiles. *Sisalation 484* is therefore ideally suited as sarking and insulation under roofs for residential and commercial buildings. *Sisalation 484*'s polymer coating provides excellent resistance to high humidity and salt laden air making the product ideal for coastal regions.

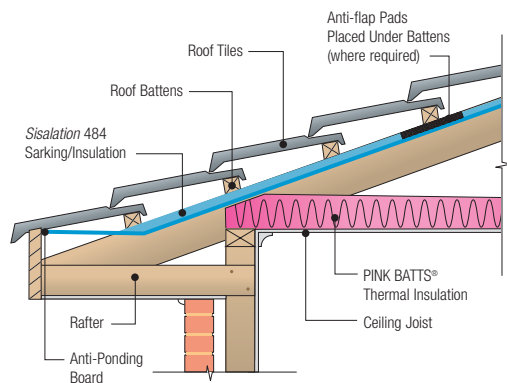

### PRODUCT FUNCTION

#### INSULATION

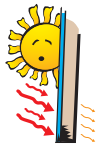

When installed in conjunction with an airspace, *Sisalation 484* provides insulation and may add an additional R0.7 to R1.8 to a tiled or metal roof structure, depending on the direction of the heat flow.

#### ENERGY EFFICIENCY



As insulation, *Sisalation 484* will reduce summer heat gain and winter heat loss in a building. Importantly this will enhance energy efficiency and help reduce greenhouse gas emissions. *Sisalation 484* has a high light reflectivity. When installed in buildings as an exposed internal roof lining, the reflectivity of the ceiling is increased by up to 40%. This reduces artificial lighting loads and further enhances energy efficiency.

#### PROTECTION



As sarking under tiled roofs, *Sisalation 484* provides an effective barrier or second skin against the ingress of wind driven rain, dust and debris entering the roof space, particularly if the roof tiles become cracked or damaged.

Under metal roofs, *Sisalation 484* will reduce the potential for condensation to occur, preventing water damage to the building fabric.

#### VAPOUR BARRIER



*Sisalation 484* will provide an effective vapour barrier when overlapped and sealed with *Insulation Solutions VapaStop™ 883* self adhesive aluminium foil tape.

#### FIRE PERFORMANCE



*Sisalation 484* is flame retardant and is suitable for use in buildings in bushfire prone areas to help lessen fire hazard by preventing the ingress of sparks into the roof space.

# SISALATION™ 484

## Extra Heavy Duty Foil Laminate



### SPECIFICATION

*Sisalation 484* satisfies the BCA requirements for sarking type materials. It complies with the requirements of AS/NZS4200.1, for “Pliable Building Membranes”, which is a deemed-to-satisfy manual

recognised by the BCA Part 3.5.1 Roof Cladding. When tested in accordance with AS1530.2 it gives a low flammability index, which satisfies the BCA Part 3.7.1 Fire Hazard Properties.

### INSTALLATION

When used as a sarking, all installation should be in accordance with AS/NZS4200.2 “Installation requirements for Pliable Building Membranes.” To provide optimum insulation values, a minimum air

space of 20mm is required adjacent to the reflective foil face. In high wind areas, it may be necessary to install anti-flap pads.

### PHYSICAL PROPERTIES

*Sisalation 484* meets or exceeds the following properties as defined by AS/NZS4200.1 for “Pliable Building Membranes”.

#### CLASSIFICATIONS:

Duty	Extra Heavy
Vapour Barrier	High
Emittance	Reflective
Water Barrier	High
Flammability Index	Low

Tensile Strength Machine Direction (kN/m)	Min 13.0
Tensile Strength Lateral Direction (kN/m)	Min 10.5
Edge Tear Resistance Machine Direction (N)	Min 90
Edge Tear Resistance Lateral Direction (N)	Min 90
Water Vapour Permeance (ng/Ns)	Max 2
Emittance of Reflective Face	Max 0.05

### CHEMICAL PROPERTIES

#### DURABILITY

When installing *Sisalation 484*, the cladding should be installed without delay.

#### RESISTANCE TO ALKALIS

Aluminium foil is susceptible to alkali attack, so *Sisalation 484* should not be used in contact with wet concrete or mortar.

### HEALTH & SAFETY

There are no known health or safety risks associated with this product for applications described in this data sheet. For additional information, or a Material Safety Data Sheet, please contact your nearest *Insulation Solutions* office.

### STANDARD ROLL SIZES

Roll Width	1500mm	1500mm
Roll Length	30m	20m
Roll Area	45m <sup>2</sup>	30m <sup>2</sup>

### SUSTAINABILITY

Sustainability...measures that satisfy the needs of people today while enhancing the quality of life for future generations. The demands on non-renewable resources for the production of energy are not

sustainable without compromising the environment. Insulation, correctly specified and installed, is one of the most beneficial products in improving energy efficiency and reducing greenhouse gas emissions.

